

# Stream & Videowall Management 1.6 user manual for Android

## INDEX

System Requirement .....	1
Google Play Download Link.....	1
Before APP Installation.....	1
Basic Operation.....	2
Home Screen.....	2
Add Clients .....	2
Add Hosts .....	5
Select Client Channel.....	8
Client Management .....	9
Set Client Info .....	9
Delete Client .....	11
TV Wall Management.....	12
Reboot Client .....	16
Set IP Mode .....	17
Auto Mode.....	17
DHCP Mode .....	17
Static IP.....	18
Set Factory Default .....	20
Launch Web.....	21
Indicator .....	22
Host Management .....	23
Preview Image .....	23
Set Host Info .....	24
Delete Host .....	26
Reboot Host.....	27
Set Host Channel.....	28
Set IP Mode .....	29
Auto Mode.....	29
DHCP Mode .....	29
Static IP.....	30
Set Factory Default .....	32
Launch Web.....	33
Indicator .....	34
Group Management.....	35
Create Group .....	35
Select Group Channel.....	37
Edit Group Info.....	39
Delete Group .....	41

# Stream & Videowall Management 1.6 user manual for Android

## System Requirement

APP name: Stream & Videowall Management

Ver. 1.6



Android version 4.1 or later

Size: 2.12M

## Google Play Download Link

<https://play.google.com/store/apps/details?id=com.sct.sctcontrollcenter1>

## Google Play Download QR code



## Before APP Installation

You have to connect Host / Client / Ethernet Switch / Access Point (Wi-Fi router) together.

Connects your mobile phone by Wi-Fi and set the IP address at same subnet with the Host / Client.

System default IP setting is Auto IP, it will assign 169.254.X.X (subnet mask 255.255.0.0) to hosts and clients, you could also set to DHCP or Static IP, please refer to user manual web setting chapter: IP Setup.

### How to get the IP address of receiver:

1. Connect monitor with receiver, **local IP** shows on right bottom screen when receiver booting or transmitter not connected( or no video input)
2. Press remote control button **MENU, 1, ENTER** (Network Information), it will shows the receiver IP Address on screen

### How to get the IP address of transmitter:

1. Connect monitor with receiver, connect receiver with transmitter and set in the same channel, **remote IP** shows on right bottom screen when receiver booting or no video input from transmitter

### Set IP address of transmitter/receiver by command:

Press and hold panel button "+" then power on to set factory default then enter engineering mode. In engineering mode Power and Link LED will be flash together, IP address of unit will be set to Static IP 192.168.0.88 temporarily, login to the web page by browser and change IP settings in API commands column as below(x can be one of numbers 1~254):

```
astparam s ip_mode static
astparam s ipaddr 169.254.x.x
astparam s netmask 255.255.0.0
astparam save
```

Commands can be applied one by one, or connected them by ";" to apply at once as below:

```
astparam s ip_mode static;astparam s ipaddr 169.254.x.x;astparam s netmask 255.255.0.0;astparam save
```

Also you could use private IP address/subnet mask you preferred like **192.168.x.x/255.255.255.0**

# Stream & Videowall Management 1.6 user manual for Android

## Basic Operation Home Screen

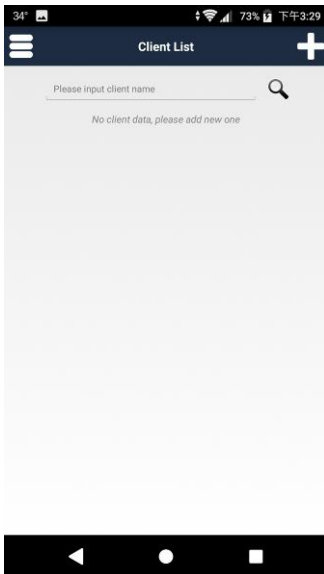

It will show Client List page when enter the APP  
Touch top right 「+」 to enter Add Client page

## Add Clients

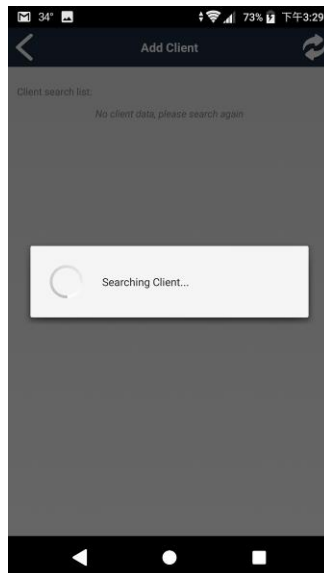

After touch 「+」 it will start search client

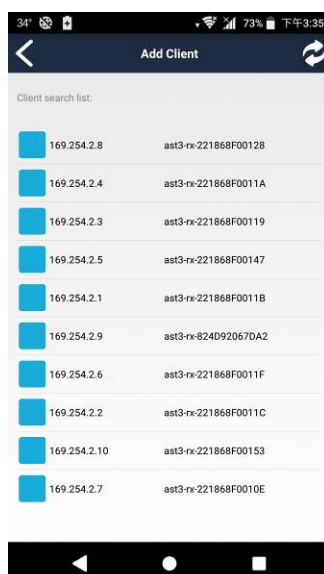

It will show all clients with pure blue icon in the list  
Touch IP address to enter client information

# Stream & Videowall Management 1.6 user manual for Android

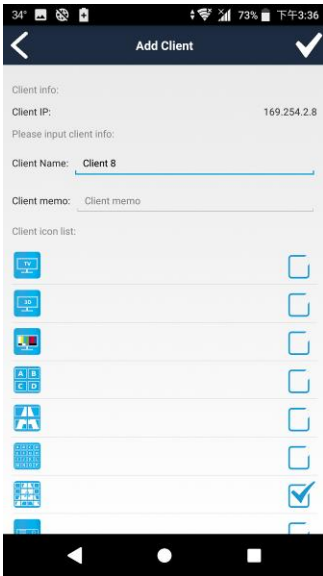

Enter the client name and memo, select the icon you prefer  
Touch top right 「✓」 button to finish setting.

**Notice: Client name must be unique and not duplicated**

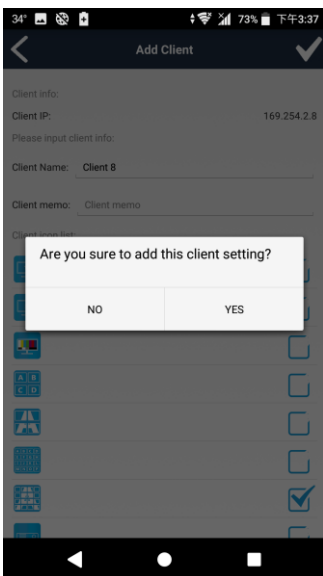

Touch 「Yes」 to confirm setting

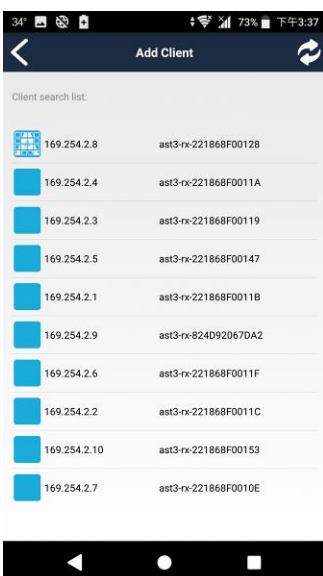

Return to Add Client page you will see the icon you selected in front of the client which you just add.

# Stream & Videowall Management 1.6 user manual for Android

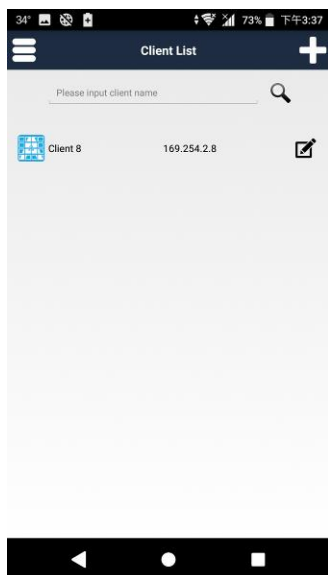

Return to Client List page you will see the client which you just add.

# Stream & Videowall Management 1.6 user manual for Android

## Add Hosts

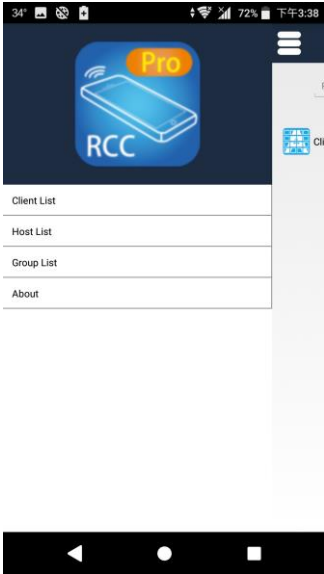

Touch top left menu bar to show full menu

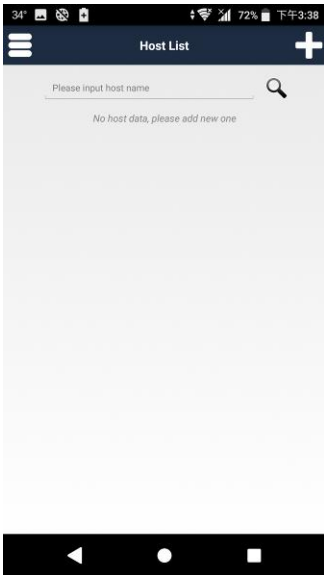

Touch top right 「+」 to enter Add Host page



After touch 「+」 it will start search host

# Stream & Videowall Management 1.6 user manual for Android

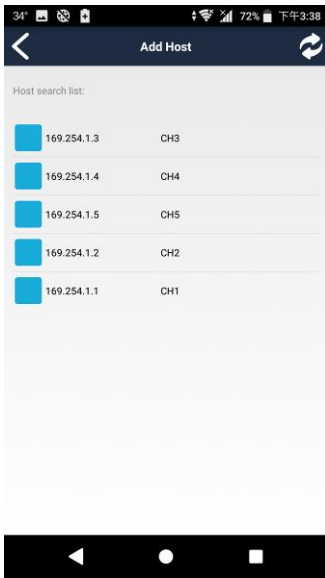

It will show all clients with pure blue icon in the list  
Touch IP address to enter host information

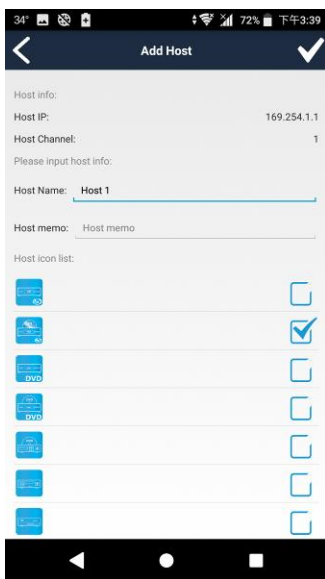

Enter the host name and memo, select the icon you prefer  
Touch top right 「✓」 button to finish setting.  
**Notice: Host name must be unique and not duplicated**

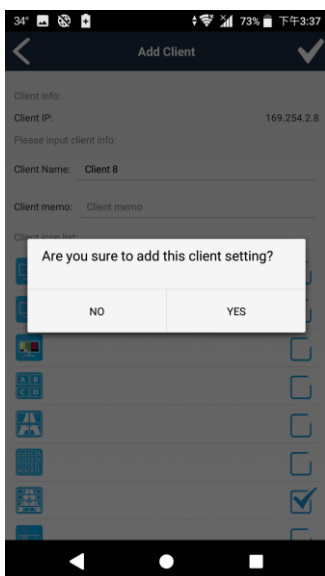

Touch 「Yes」 to confirm setting

# Stream & Videowall Management 1.6 user manual for Android

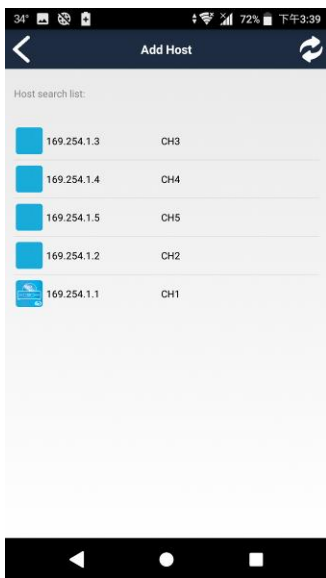

Return to Add Host page you will see the icon you selected in front of the client which you just add.

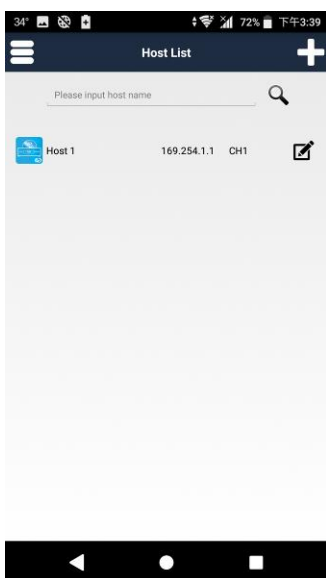

Return to Client List page you will see the client which you just add.



# Stream & Videowall Management 1.6 user manual for Android

## Select Client Channel

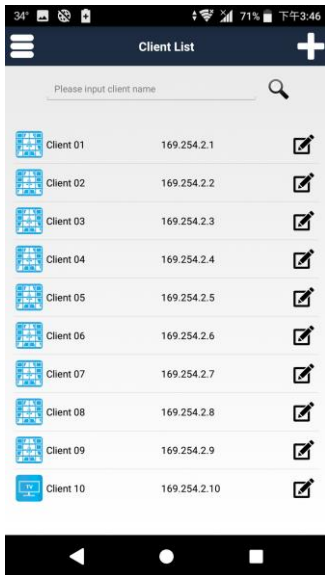

Left: Icon and name of clients  
Center: IP address of clients  
Right: client management

Touch client column to enter Client Source page

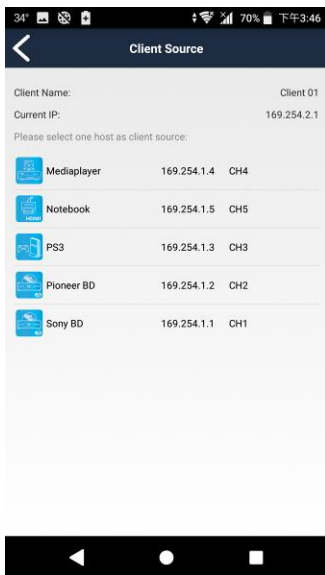

In Client Source page it will list all register hosts for selection

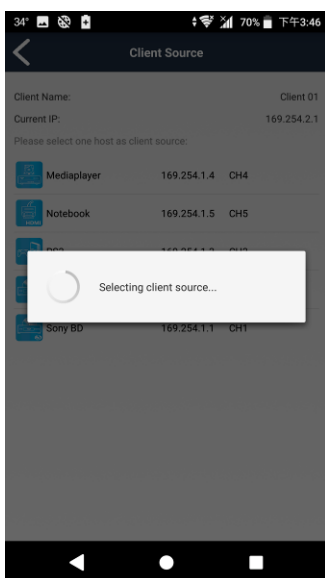

Touch the host icon to select  
The selected channel will be switch immediately

# Stream & Videowall Management 1.6 user manual for Android

## Client Management Set Client Info

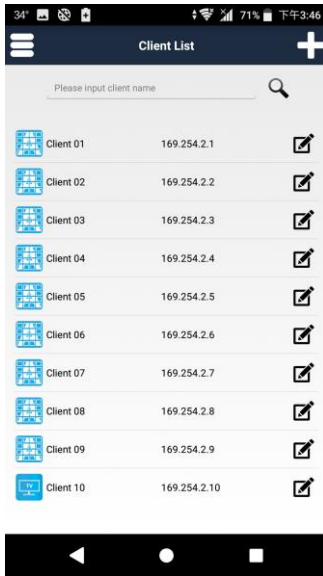

Touch right pencil icon in client list to enter Client Management page

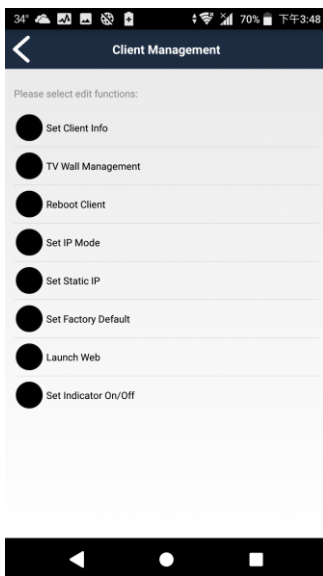

Touch Set Client Info

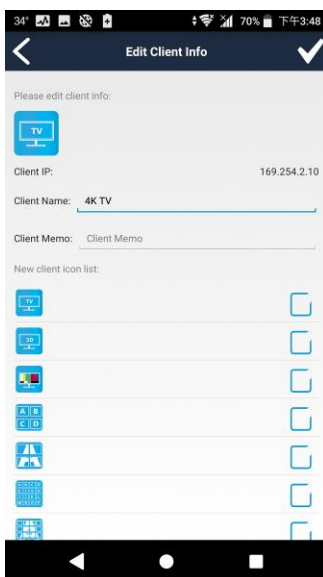

You can change client name, memo and icon  
Touch top right 「✓」 button to finish setting

# Stream & Videowall Management 1.6 user manual for Android

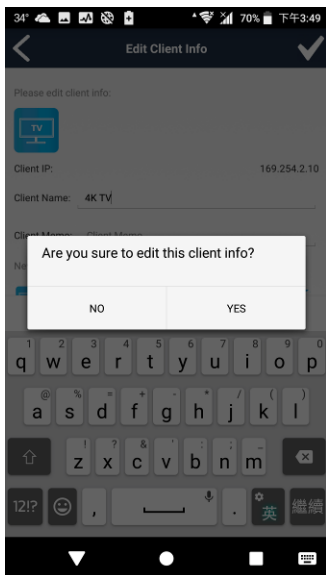

Touch 「Yes」 to confirm setting

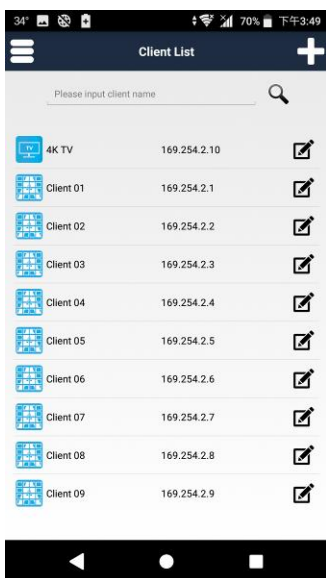

Return to Client List the client name or icon have been changed

# Stream & Videowall Management 1.6 user manual for Android

## Delete Client

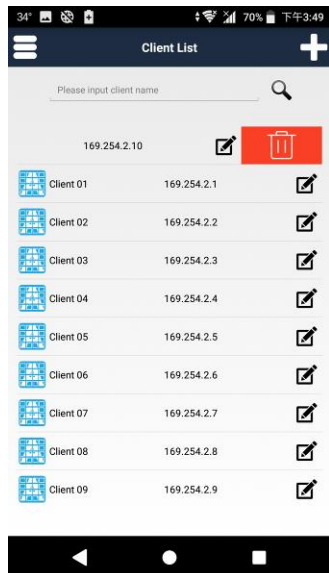

Drag client name to left to trash can icon

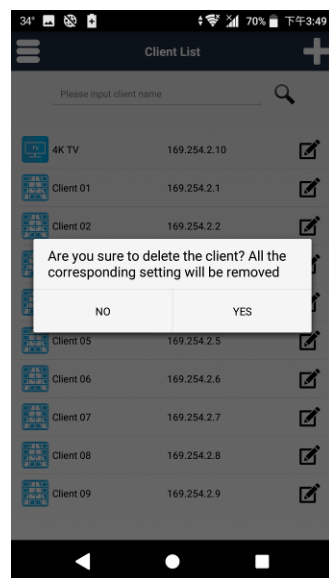

Touch 「Yes」 to confirm  
All the corresponding setting will be removed

# Stream & Videowall Management 1.6 user manual for Android

## TV Wall Management

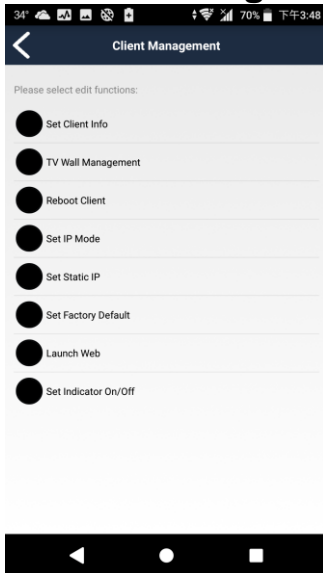

Touch TV Wall Management to enter Edit Client TV Wall page



You could select default layout as 1\*1(single), 2\*2, 3\*3, 4\*4 in below then touch 「>」 icon

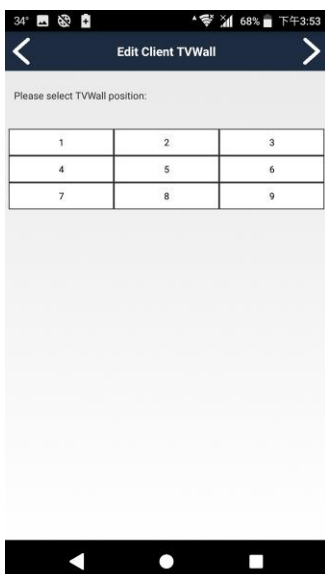

It will show the TV wall layout you select

# Stream & Videowall Management 1.6 user manual for Android

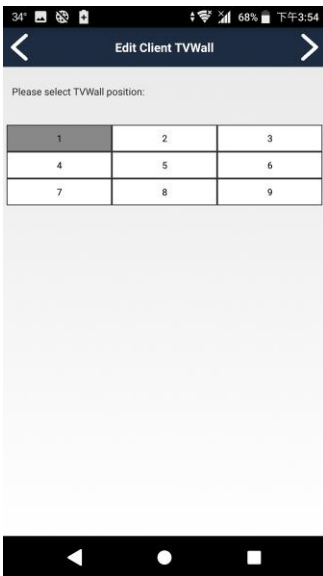

Choice position of this monitor of RX in TV wall then touch 「>」 icon



It will show detail coordinate and size of TV wall, you could adjust the number if you want to shift the position.

After setting please touch 「>」 icon



Touch 「Yes」 to confirm setting

You will see the monitor have been changed to TV wall mode

# Stream & Videowall Management 1.6 user manual for Android



Or you could set columns and row manually, maximum 8 rows 16 columns



Choice position of this monitor of RX in TV wall then touch 「>」 icon



It will show detail coordinate and size of TV wall, you could adjust the number if you want to shift the position, rotate the screen.

After setting please touch > icon

# Stream & Videowall Management 1.6 user manual for Android

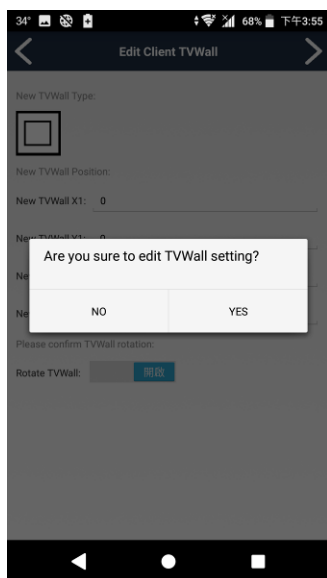

Touch 「Yes」 to confirm setting

You will see the monitor have been changed to TV wall mode



# Stream & Videowall Management 1.6 user manual for Android

## Reboot Client

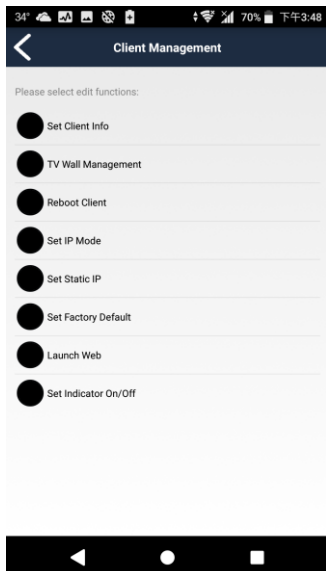

Touch Reboot Client to enter Reboot Client page

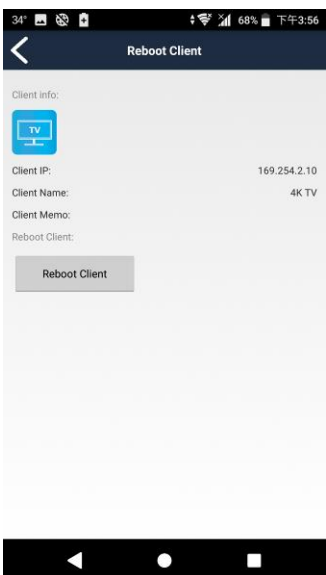

Touch 「Reboot Client」 to confirm setting

# Stream & Videowall Management 1.6 user manual for Android

## Set IP Mode

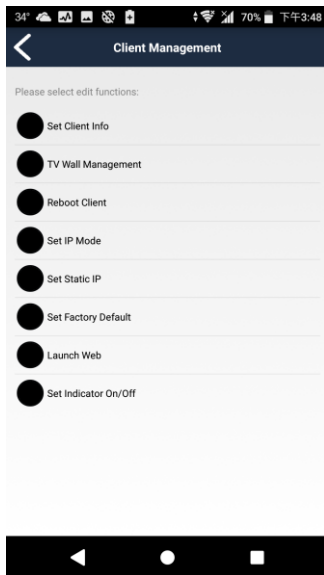

Touch Set IP Mode to enter Set IP Mode page

## Auto Mode

IP assigned by client itself as 169.254.x.x, it will be changed automatically if duplicate IP detected.

## DHCP Mode

IP address assigned by DHCP server

**Notice: If there is no DHCP server exist the client will not able to work, you have to reboot the client to renew IP address once the DHCP server available, or set the client to factory default by MENU function 333 to switch to Auto Mode**

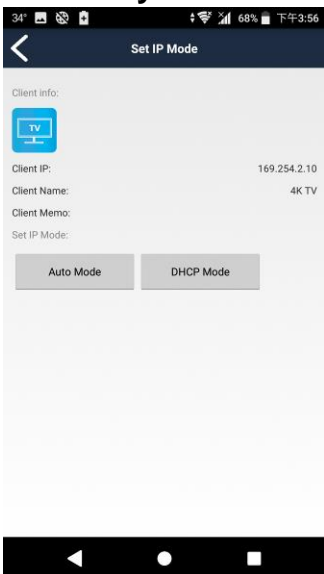

Touch 「Auto Mode」 or 「DHCP Mode」 to set IP mode

# Stream & Videowall Management 1.6 user manual for Android



Touch 「Yes」 to confirm setting  
Client will be reboot automatically

## Static IP

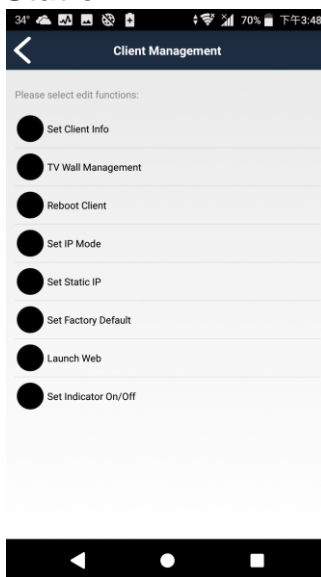

Touch Set Static IP to enter Set Static IP page

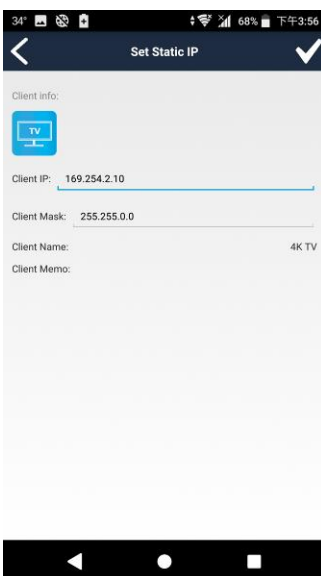

Enter IP address and subnet mask then touch top right 「✓」 button to finish setting  
Client will be reboot automatically

# Stream & Videowall Management 1.6 user manual for Android

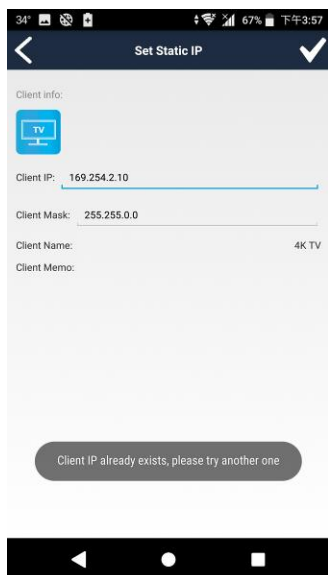

**Notice: IP address must be unique and not duplicated  
It will show warning message if IP address already exist**

# Stream & Videowall Management 1.6 user manual for Android

## Set Factory Default

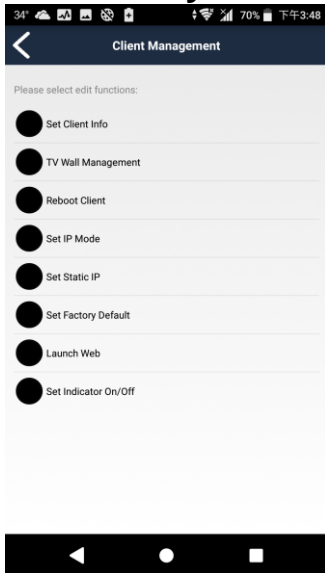

Touch Set Factory Default to enter Set Factory Default page



Touch Set Factory Default

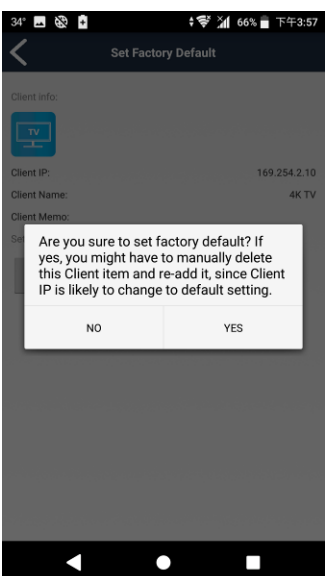

Touch 「YES」 to confirm  
Client will be reboot automatically

# Stream & Videowall Management 1.6 user manual for Android

## Launch Web

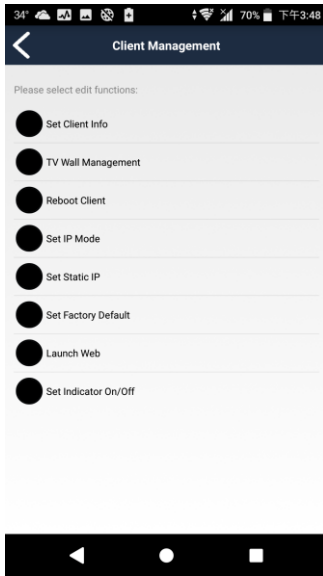

Touch Launch Web

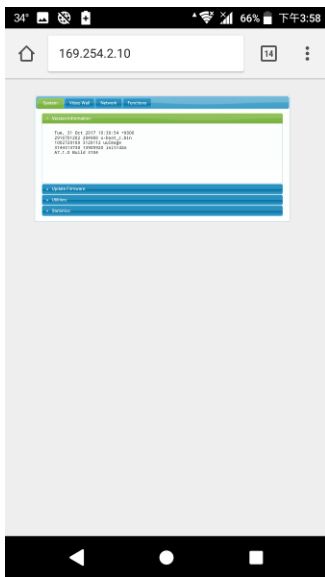

It will open browser and login to the web of client  
For detail settings please refer user manual

# Stream & Videowall Management 1.6 user manual for Android

## Indicator

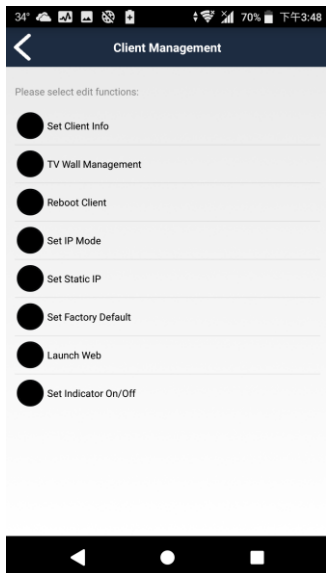

Touch Set Indicator On/Off to enter setting page

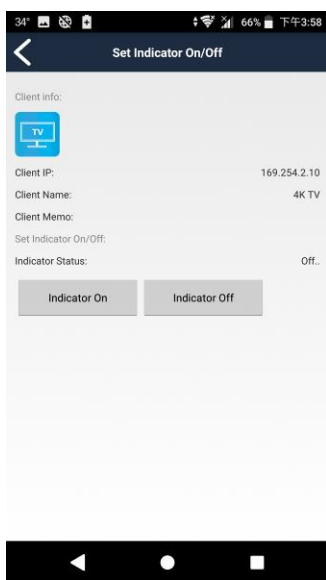

Touch Indicator On, the power LED of host will keep flashing and show OSD message "I am here" on monitor

Touch Indicator Off to stop indicating

# Stream & Videowall Management 1.6 user manual for Android

## Host Management

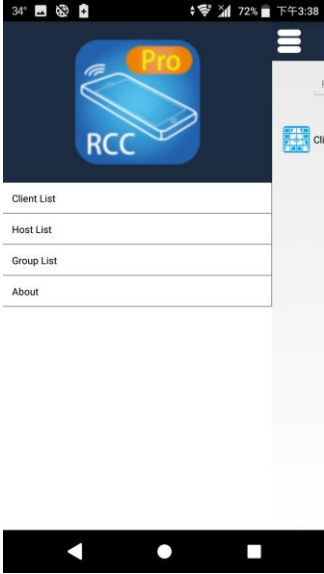

Touch top left menu bar to show full menu

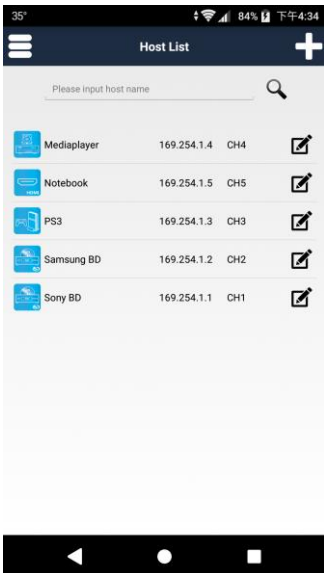

It will show status of registered hosts while enter the page:

IP address: default is 169.254.xxx.xxx, subnet mask 255.255.0.0  
Channel number: 0~999

## Preview Image

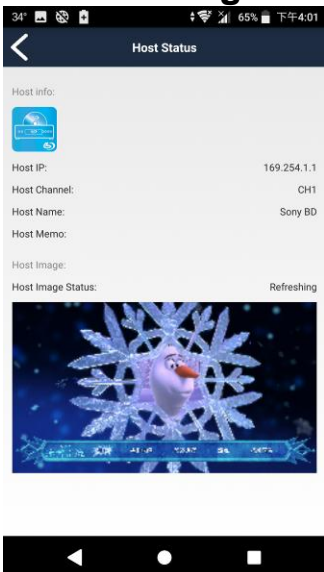

Touch host to preview image of source to make sure the content is correct before switch to, the image will refreshing automatically



# Stream & Videowall Management 1.6 user manual for Android

## Set Host Info

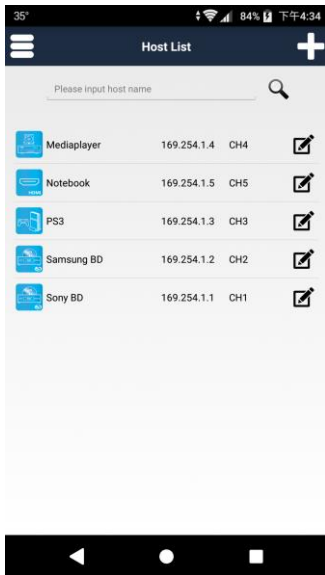

Touch right pencil icon in client list to enter Host Management page

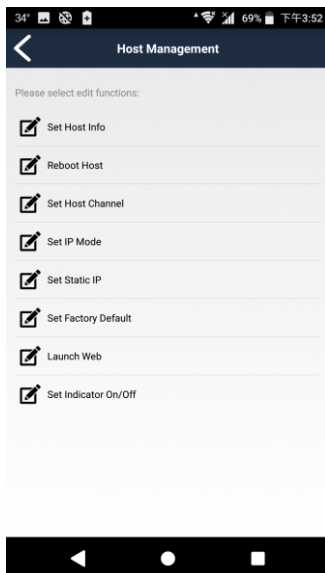

Touch Set Host Info

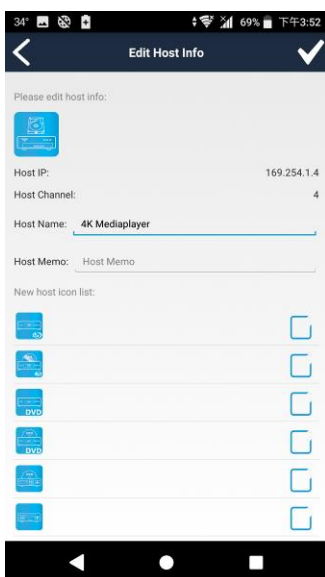

You can change host name, memo and icon  
Touch top right 「✓」 button to finish setting

# Stream & Videowall Management 1.6 user manual for Android

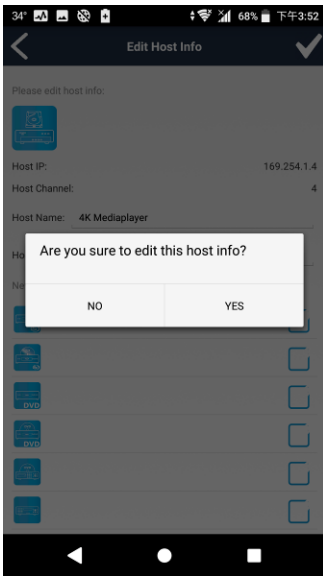

Touch 「Yes」 to confirm setting

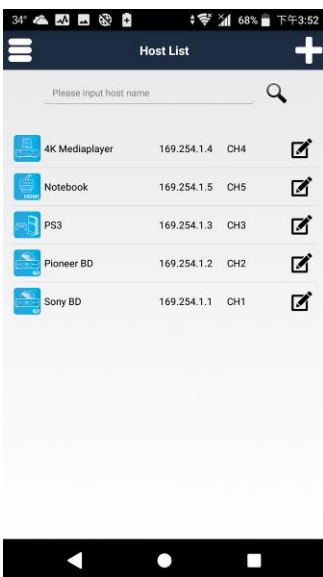

Return to Host List the host name or icon have been changed

# Stream & Videowall Management 1.6 user manual for Android

## Delete Host

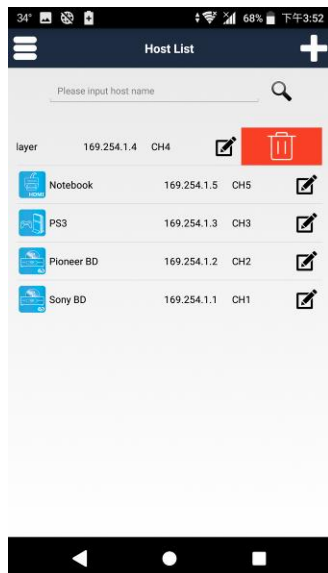

Drag client name to left to trash can icon

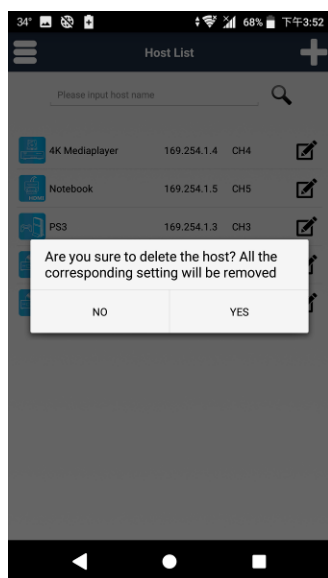

Touch 「Yes」 to confirm  
All the corresponding setting will be removed

# Stream & Videowall Management 1.6 user manual for Android

## Reboot Host

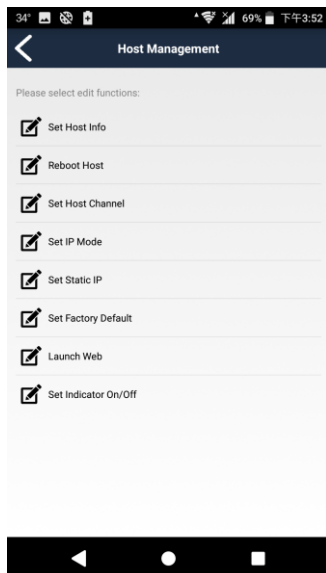

Touch Reboot Host to enter Reboot Host page

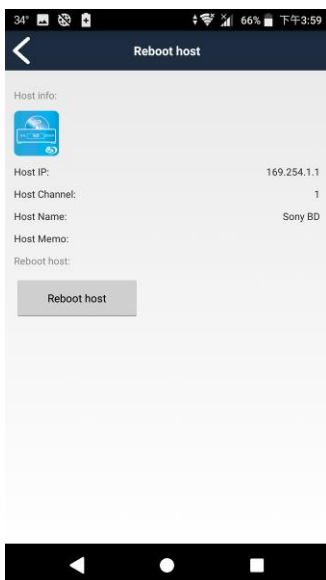

Touch 「Reboot Host」 to confirm setting

# Stream & Videowall Management 1.6 user manual for Android

## Set Host Channel

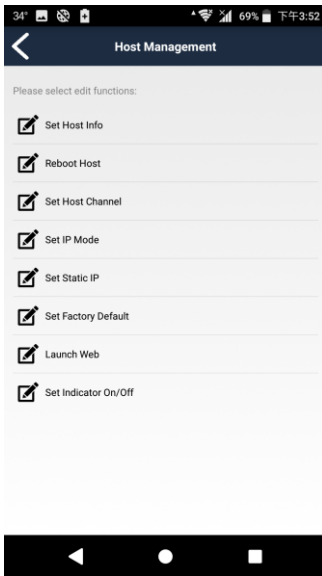

Touch Set Host Channel enter setting page



Enter channel number (0~999) then touch top right 「✓」 button to finish setting

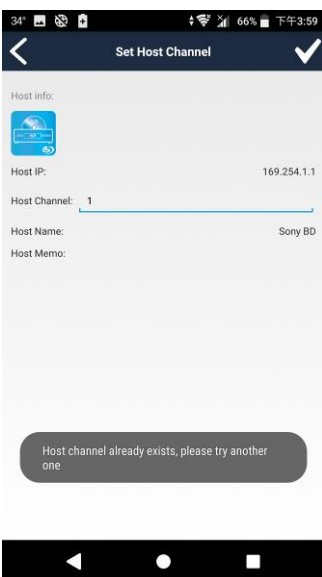

**Notice: Channel number must be unique and not duplicated  
It will show warning message if channel number already exist**

# Stream & Videowall Management 1.6 user manual for Android

## Set IP Mode

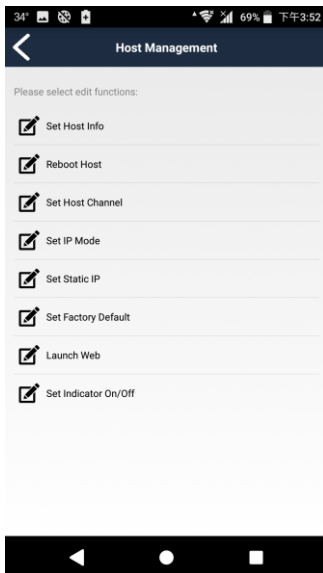

Touch Set IP Mode to enter Set IP Mode page

## Auto Mode

IP assigned by client itself as 169.254.x.x, it will be changed automatically if duplicate IP detected.

## DHCP Mode

IP address assigned by DHCP server

**Notice: If there is no DHCP server exist the host will not able to work, you have to reboot the client to renew IP address once the DHCP server available, or set the host to factory default by MENU function 333 to switch to Auto Mode**

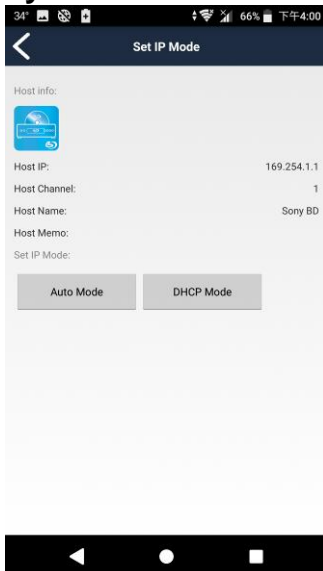

Touch 「Auto Mode」 or 「DHCP Mode」 to set IP mode

# Stream & Videowall Management 1.6 user manual for Android

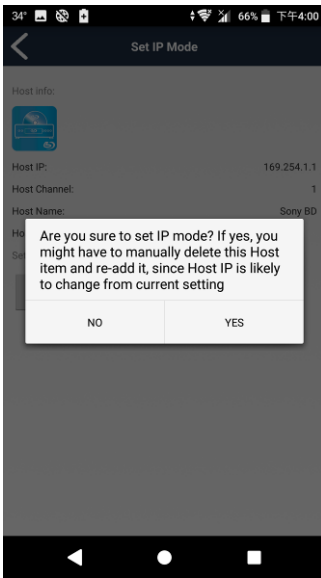

Touch 「Yes」 to confirm setting  
Host will be reboot automatically

## Static IP

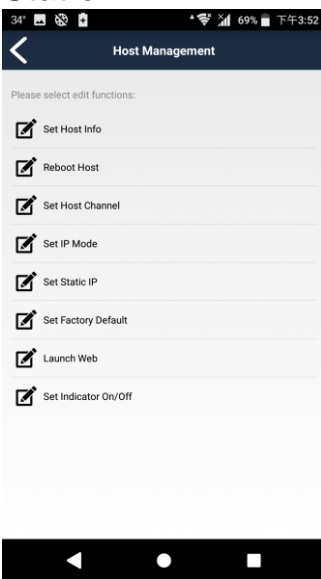

Touch Set Static IP to enter Set Static IP page

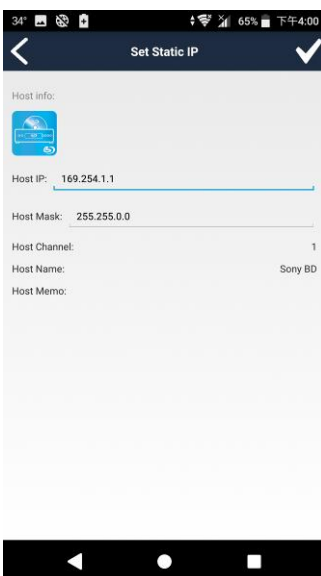

Enter IP address and subnet mask then touch top right 「✓」 button to finish setting  
Host will be reboot automatically

# Stream & Videowall Management 1.6 user manual for Android

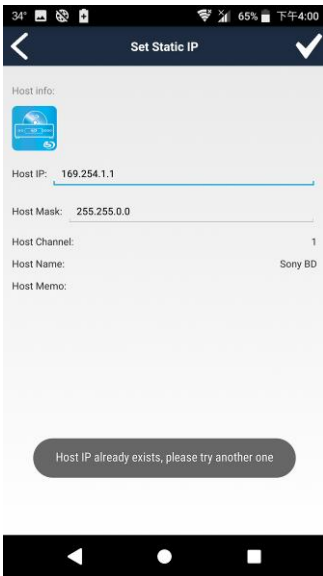

**Notice: IP address must be unique and not duplicated  
It will show warning message if IP address already exist**



# Stream & Videowall Management 1.6 user manual for Android

## Set Factory Default

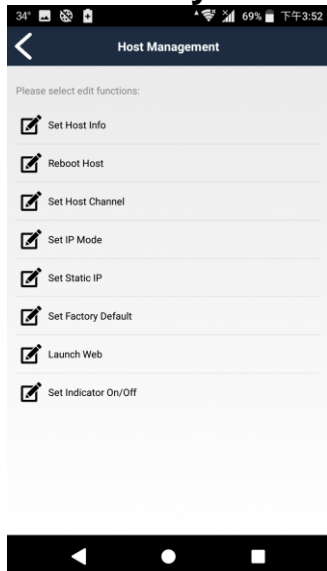

Touch Set Factory Default to enter setting page

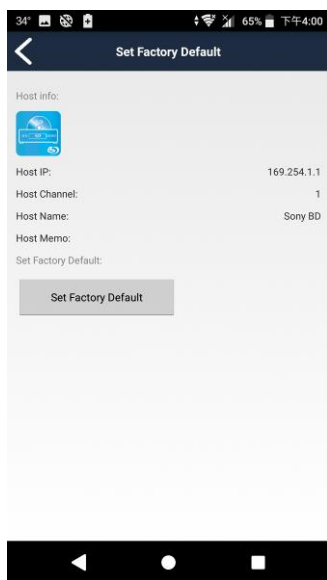

Touch Set Factory Default

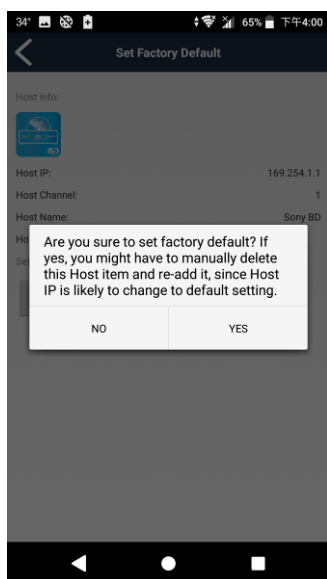

Touch 「YES」 to confirm  
Host will be reboot automatically

# Stream & Videowall Management 1.6 user manual for Android

## Launch Web

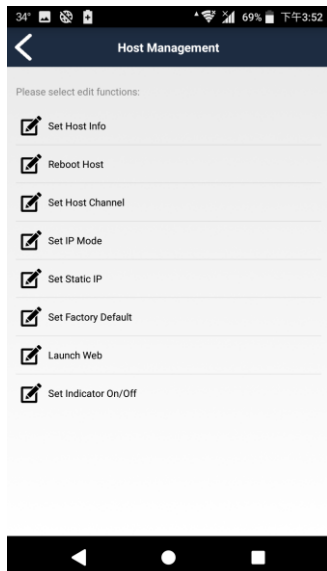

Touch Launch Web

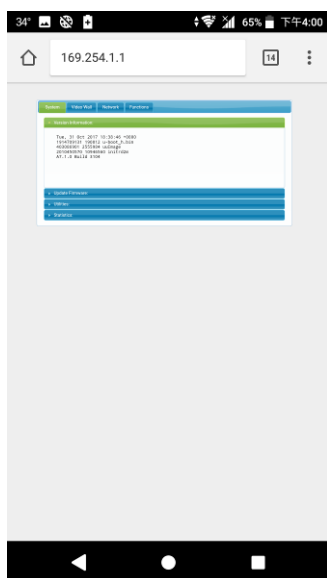

It will open browser and login to the web of host  
For detail settings please refer user manual

# Stream & Videowall Management 1.6 user manual for Android

## Indicator

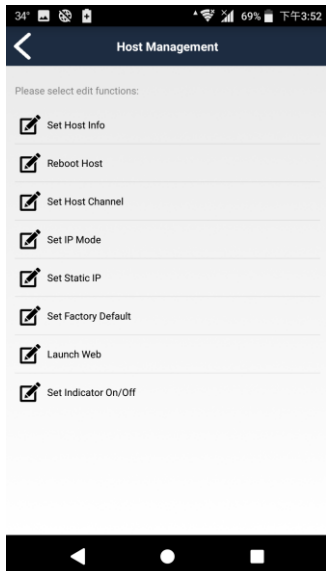

Touch Set Indicator On/Off to enter setting page

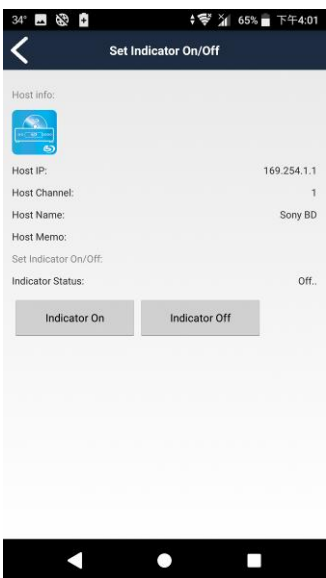

Touch Indicator On, the power LED of host will keep flashing

Touch Indicator Off to stop indicating

# Stream & Videowall Management 1.6 user manual for Android

## Group Management Create Group

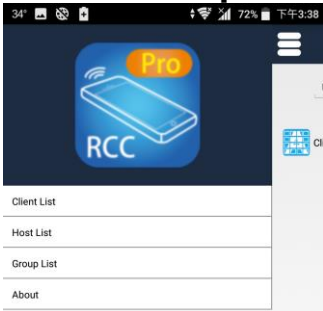

Touch top left menu bar to show full menu

Touch bottom right 「Edit」 at Client page to enable select function

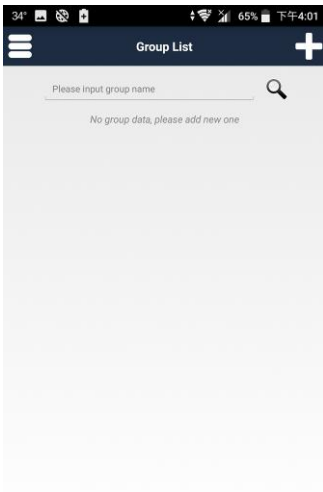

Touch top right 「+」 to enter Add Host page

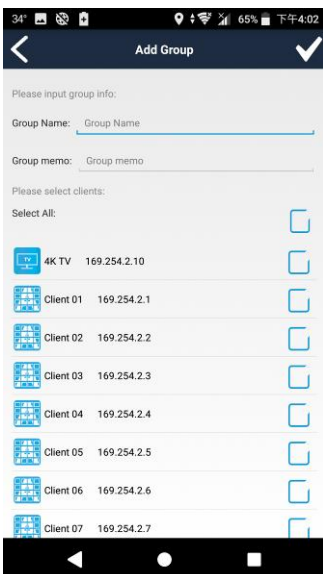

Touch top right 「+」 to enter Add Host page

# Stream & Videowall Management 1.6 user manual for Android

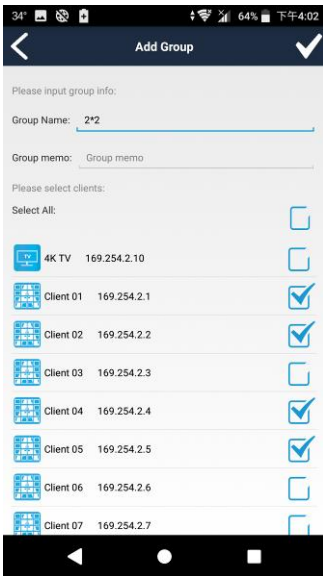

Enter the group name and memo, select the client you prefer  
Touch top right 「✓」 button to finish setting.

**Notice: Group name must be unique and not duplicated**

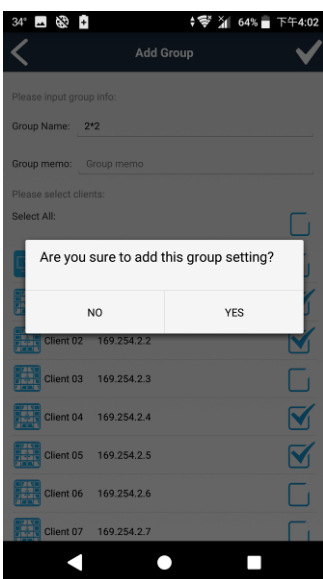

Touch 「Yes」 to confirm setting

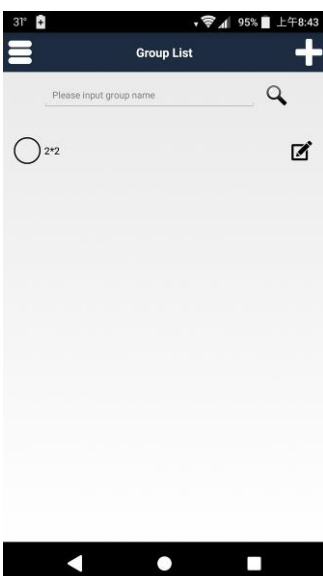

Return to Group List page you will see the group which you just add.

# Stream & Videowall Management 1.6 user manual for Android

## Select Group Channel

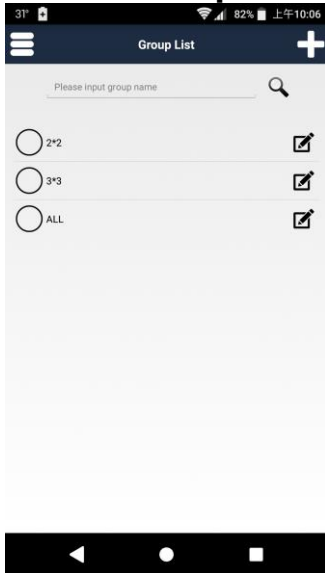

Touch group column to enter Group Source page

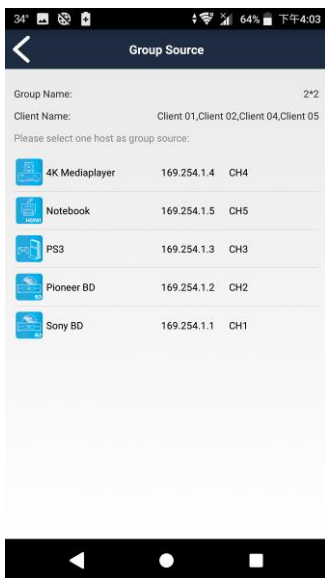

In Group Source page it will list all register hosts for selection

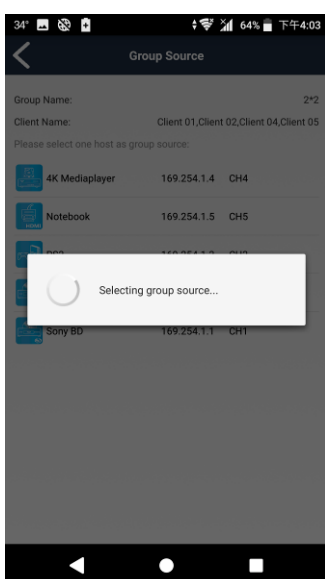

Touch the host icon to select  
The selected channel will be switch immediately

# Stream & Videowall Management 1.6 user manual for Android



Yellow area shows the devices of group

Gray area shows the available channels

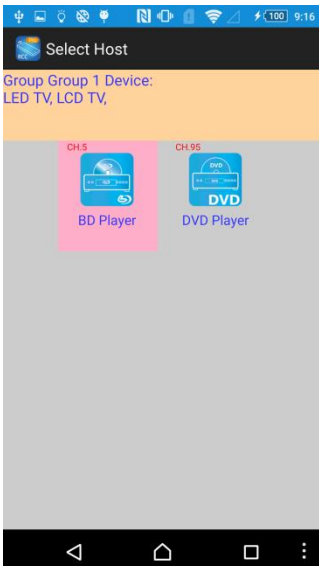

Touch the host icon to select

The selected channel will be high light and switch the screen immediately

# Stream & Videowall Management 1.6 user manual for Android

## Edit Group Info

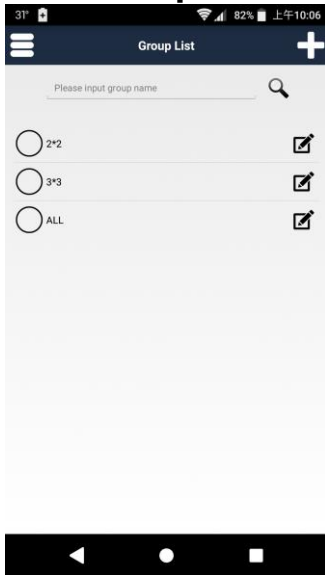

Touch right pencil icon in group list to enter Edit Group Info page

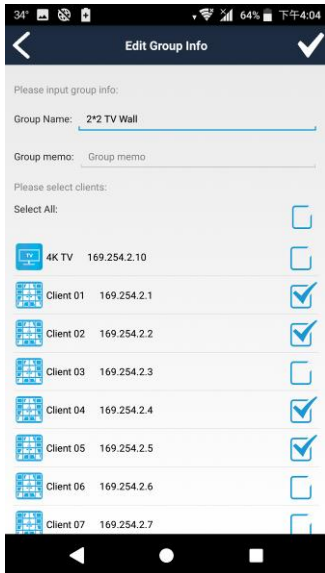

You can change group name, memo and add/remove client  
Touch top right 「✓」 button to finish setting

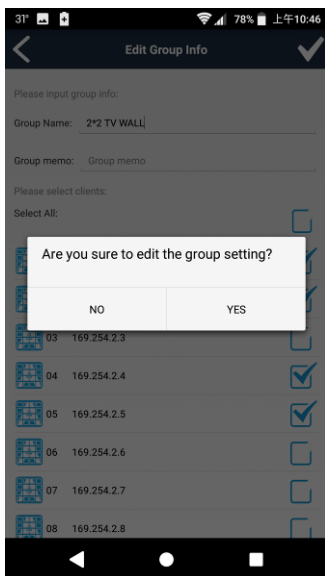

Touch 「Yes」 to confirm setting



# Stream & Videowall Management 1.6 user manual for Android



Return to Group List the group name have been changed

# Stream & Videowall Management 1.6 user manual for Android

## Delete Group



Drag client name to left to trash can icon

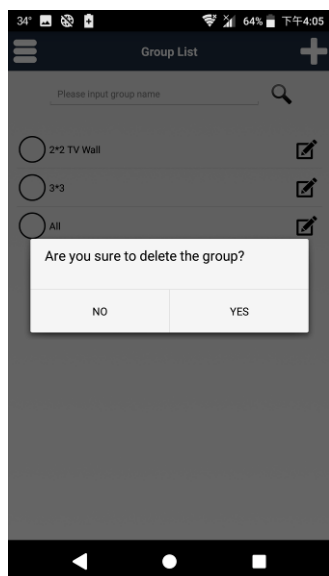

Touch 「Yes」 to confirm and the group will be removed